

## The New and Revamped Indonesia Airports



*Sultan Hasanuddin International Airport*

Since early 2000 Fast Flow has completed over 70 airport projects and drained more than 3,000,000 square metres of airports' roof area in Asia Pacific. For over a decade, Fast Flow has been working closely with its licensed distributor (Siphonic Flow Mandiri) in promoting the company's products and systems in Indonesia. Together they secured and completed 20 airport projects nationwide. The projects include Sultan Hasanuddin International Airport (Makassar, Sulawesi), Kualanamu International Airport (Medan, Sumatra), Ngurah Rai International Airport (Denpasar, Bali), Komodo Labuan Bajo Airport (Labuan Bajo, Flores) and Soekarno Hatta International Airport Terminal 3 Ultimate (Jakarta, Indonesia).

It is an exciting time for airports nationwide. Despite the pandemic, there are big improvements coming to airports in Indonesia. Whether it is new construction or work finishing up on existing projects, there is lots to look forward to if you are passing through Indonesia domestic airports over the coming months. In the past two years Fast Flow has secured six airports projects with the help of Siphonic Flow Mandiri. The big winners are the two large airports in Sulawesi and Java, which are all undergoing massive redevelopment projects. Other major airports are also getting big upgrades, and we will cover some of the highlights below.

*Image source: [www.skyscrapercity.com](http://www.skyscrapercity.com)*

### Inside this issue...

- ▣ The New and Revamped Indonesia Airports
- ▣ Airports Special - Indonesia

- ▣ Project Highlights – APAC
- ▣ Our Presence





Project Name : New Yogyakarta International Airport  
 Project Location : Kulon Progo, Yogyakarta  
 Material : UPVC, HDPE & GI  
 Design RFI : 330 mm/hr  
 Catchment Area : 120,000 sqm



Project Name : Lombok International Airport  
 Project Location : Lombok, West Nusa Tenggara  
 Material : UPVC  
 Design RFI : 330 mm/hr  
 Catchment Area : 13,160 sqm



Project Name : Sam Ratulangi International Airport  
 Project Location : Manado, North Sulawesi  
 Material : Cast Iron  
 Design RFI : 330 mm/hr  
 Catchment Area : 15,888 sqm

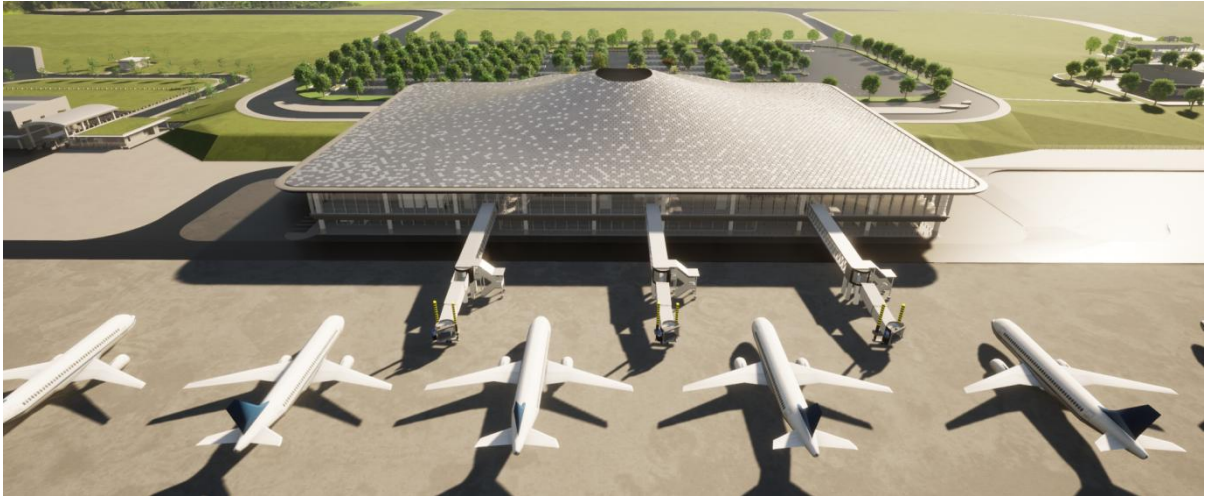

Project Name : Dhoho Airport  
 Project Location : Kediri, East Java  
 Pipe Material : HDPE pipes & SS304  
 Design RFI : 300 mm/hr  
 Catchment Area : 26,176 sqm



Project Name : Sultan Hasanuddin International Airport (expansion)  
 Project Location : Makassar, South Sulawesi  
 Material : UPVC  
 Design RFI : 330 mm/hr  
 Catchment Area : 89,673 sqm



Project Name : Mutiara SIS Al-Jufri Airport (revamp project)  
 Project Location : Palu, Central Sulawesi  
 Material : UPVC  
 Design RFI : 400 mm/hr  
 Catchment Area : 7,084 sqm



## Fast Flow Group Newly Secured Projects Q3/2022

### Singapore

- Northumberland Residences
- HDB Tengah Park C8
- Singapore Land Tower
- Silicon Box at Tampines Industrial Ave 3
- Shaw Tower Redevelopment

### Malaysia

- Pantai Hospital Expansion
- Seri Yakin Logistic (YTL)
- Riveria Sentral Phase 1
- TTM Penang Science Park
- AT&S Factory Kulim
- KD10 (Sunway d'hill)
- MCT Alira Metropark Subang

### Thailand

- North Plot-N1
- North Plot-N2
- North Plot-N3

### Indonesia

- Dhoho Airport Kediri
- Tabernacle Family Church (Gereja Kemah Tabernakel)

### Australia

- 37 Houghton Street

## North Plot Samutprakarn, Thailand



Project Name: North Plot-N1, North Plot-N2 and North Plot-N3  
Total Catchment area: 31,363 sqm

## Piccadilly Grand Singapore



Project Name: Piccadilly Grand  
Total Catchment area: 1,860 sqm

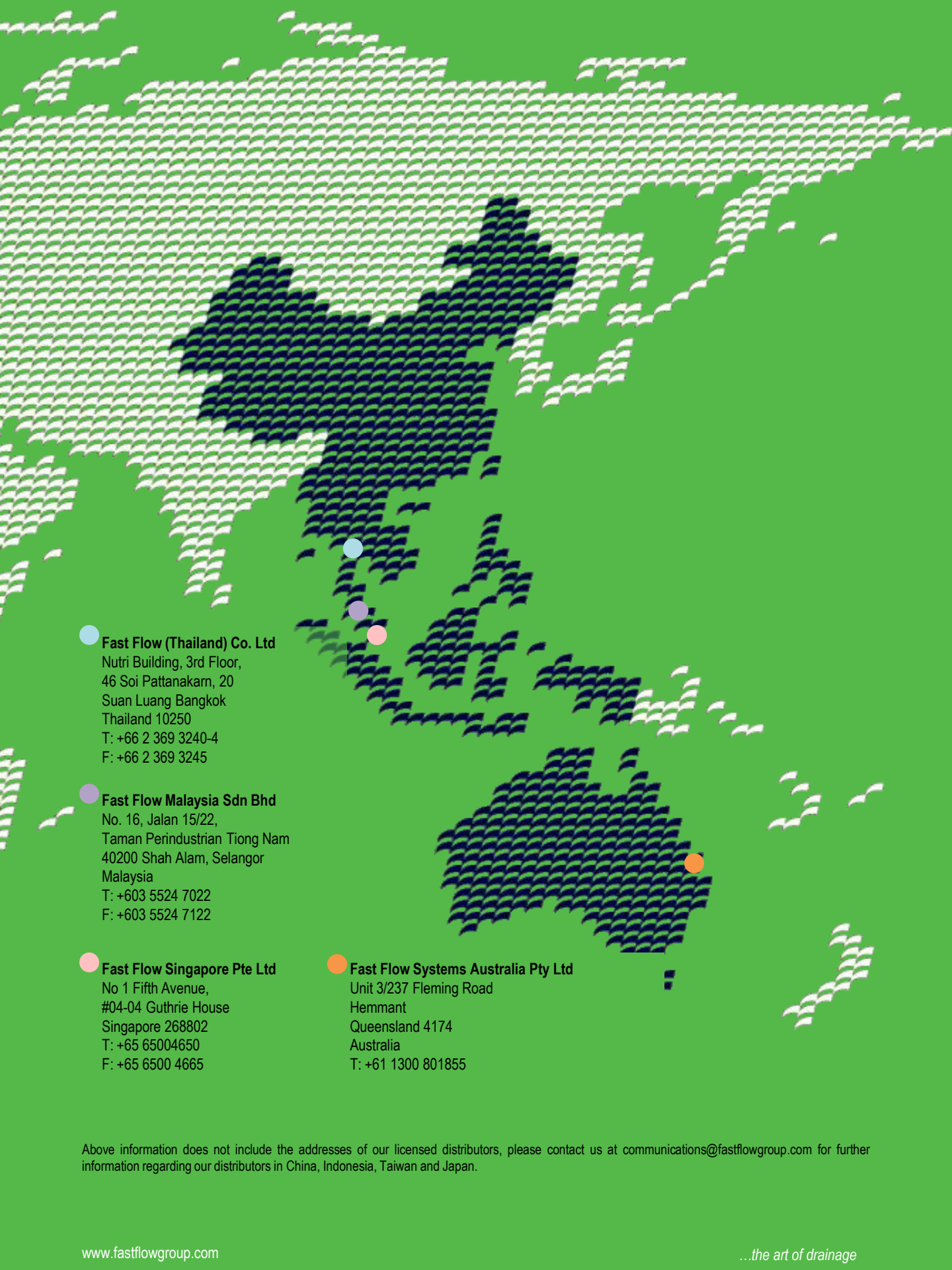

**Fast Flow (Thailand) Co. Ltd**

Nutri Building, 3rd Floor,  
46 Soi Pattanakarn, 20  
Suan Luang Bangkok  
Thailand 10250  
T: +66 2 369 3240-4  
F: +66 2 369 3245

**Fast Flow Malaysia Sdn Bhd**

No. 16, Jalan 15/22,  
Taman Perindustrian Tiong Nam  
40200 Shah Alam, Selangor  
Malaysia  
T: +603 5524 7022  
F: +603 5524 7122

**Fast Flow Singapore Pte Ltd**

No 1 Fifth Avenue,  
#04-04 Guthrie House  
Singapore 268802  
T: +65 65004650  
F: +65 6500 4665

**Fast Flow Systems Australia Pty Ltd**

Unit 3/237 Fleming Road  
Hemmant  
Queensland 4174  
Australia  
T: +61 1300 801855

Above information does not include the addresses of our licensed distributors, please contact us at [communications@fastflowgroup.com](mailto:communications@fastflowgroup.com) for further information regarding our distributors in China, Indonesia, Taiwan and Japan.